



Jofeh Neighborhood Upgrading Project

Presentation to Amman Commission
Aug 30, 2006

- CSBE work
- Project Brief
- Goals
- Assets
- Challenges
- Processes
- Next Steps

CSBE

Center for the Study of the Built Environment



The Center for the Study of the Built Environment (CSBE) is a non-profit, independent, private study and research institution that aims at addressing the challenges affecting the built environment.



In order to accomplish its goals, CSBE engages in a variety of activities:

- Research projects with strong outreach component
- Design and implementation of pilot projects
- Working as a research arm for the local government

Project Brief

CSBE

Jofeh Neighborhood Development Project

Community-based and feasible design solutions for a public space that faces common challenges. The project is a collaboration between public and private stakeholders. CSBE is funded by the Goethe Institute to play an advisory role where it facilitates the community's strong involvement in the decision-making process.

Assets

CSBE

Jofeh Neighborhood Development Project



- Unique urban fabric
- Strong sense of ownership among the community members
- GAM's commitment to engage local communities in the planning process

Assets

CSBE

Jofeh Neighborhood Development Project



Challenges

CSBE

Jofeh Neighborhood Development Project

- Physical
- Non-physical

Challenges: Green Pocket

CSBE

Jofeh Neighborhood Development Project

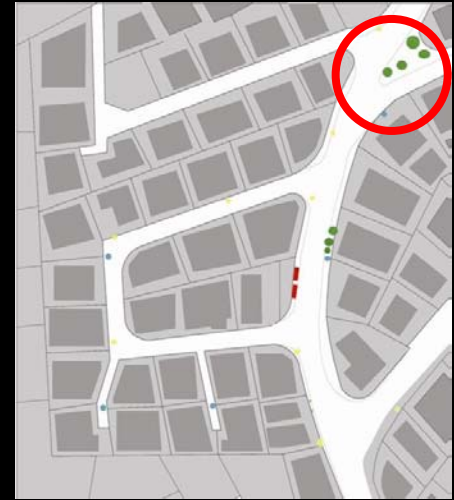

Challenges: Speed

CSBE

Jofeh Neighborhood Development Project

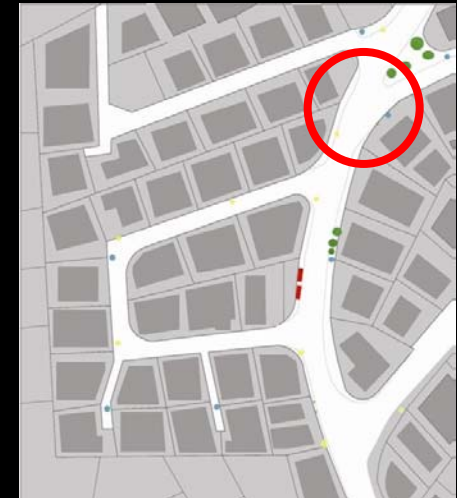

Challenges: Sidewalks

CSBE

Jofeh Neighborhood Development Project

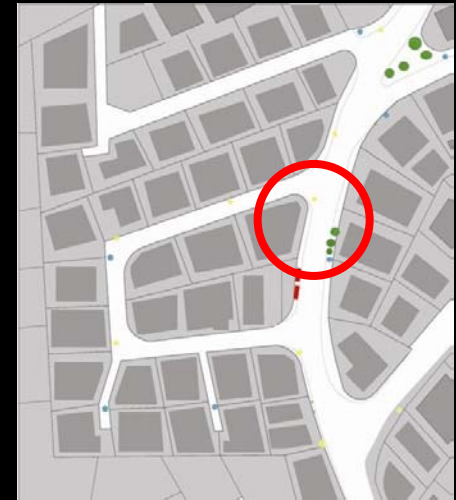

Challenges: Sidewalks

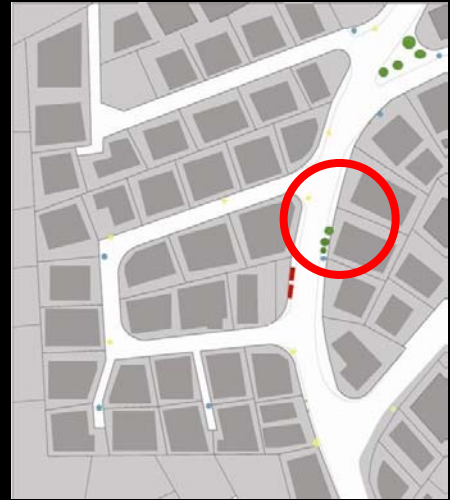

Challenges: Garbage

CSBE

Jofeh Neighborhood Development Project

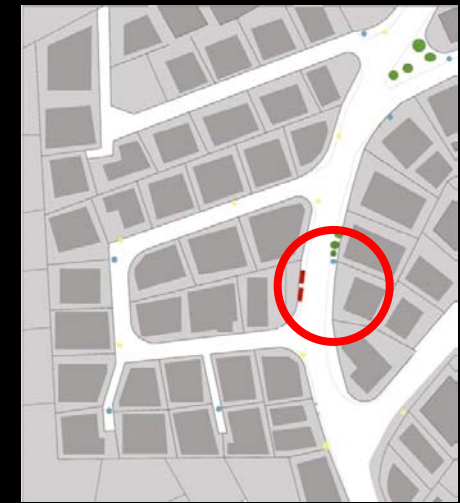

Challenges: Parking

CSBE

Jofeh Neighborhood Development Project

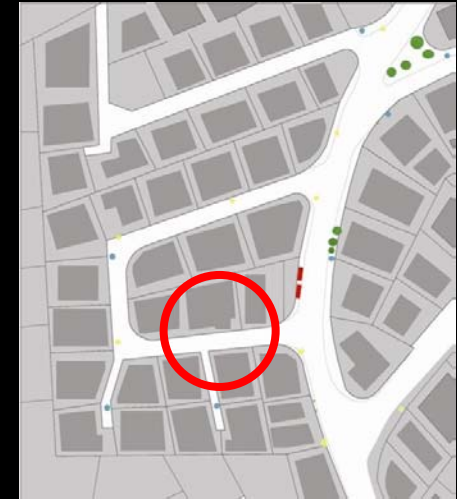

- Lack of connection between the community and GAM. Information about the community's rights and duties is difficult to access
- Absence of institutional frameworks that would channel the community's efforts

Provide technical support to the community to reach its vision

Create a series of processes that community-based organizations and local governments can adopt when designing public spaces

Raise awareness about channels through which local communities can improve their built environment and increase their sense of ownership

Goals

CSBE

Jofeh Neighborhood Development Project



Raise awareness among designers, developers, and policy-makers about the ways through which local communities can engage in the decision-making processes

Goals

CSBE

Jofeh Neighborhood Development Project



- Four Community Meetings
- Windshield Survey
- Behavior Mapping
- Questionnaire
- Design Charrettes

Four Community Meetings

Processes

CSBE

Jofeh Neighborhood Development Project



Processes

CSBE

Jofeh Neighborhood Development Project



Windshield Survey

- 26 structures
- 89 households
- 400 residents
- 41 cars

Processes

CSBE

Jofeh Neighborhood Development Project



Behavior Mapping

Processes

CSBE

Jofeh Neighborhood Development Project

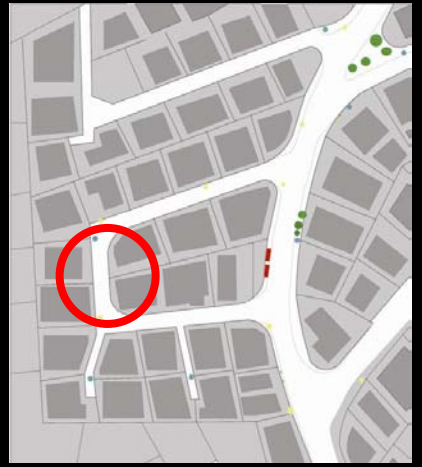

Processes

CSBE

Jofeh Neighborhood Development Project

Questionnaire

استبيان لأهالي الحيّ

Page 1 of 4

مركز دراسات البيئة المبنية

أهالي الحيّ الكرام
تحية طيبة وبعد،

تمّ تصميم هذا الاستبيان من قِبل مركز دراسات البيئة المبنية للتعرف على احتياجاتكم من أجل إيجاد أكثر الحلول ملاءمة لقضايا الحيّ المُ
ولذلك ومن أجل ضمان أفضل النتائج، الرجاء أن تتم تعبئة هذا الاستبيان من قِبل ربّ العائلة ومن جميع أفراد الأسرة ممّن يهتمهم النهوض بالحيّ، ونكم جزيل الش

تعبئة الاستبيان تستغرق 10 دقائق فقط

اسم ربّ العائلة (تعبئة هذا البند اختياريّه)

هاتف المنزل/ الخليوي (تعبئة هذا البند اختياريّه)

الرجاء وضع دائرة على الجواب الصحيح أو الأكثر صحّة

1	كيف تقيّم الحيّ كمكان للسكن؟	جيد جداً	جيد	سيّئ	لا رأي	
2	كيف تقيّم المظهر الإجمالي للحيّ؟	جيد جداً	جيد	سيّئ	لا رأي	
3	كيف تقيّم النظافة العامة للحيّ؟	جيد جداً	جيد	سيّئ	لا رأي	
4	كيف تقيّم توفر أماكن الترفيه العامة في الحيّ؟	جيد جداً	جيد	سيّئ	لا رأي	
5	بند متى وأنت تسكن هذا الحيّ؟	عام واحد	1 إلى 5 أعوام	5 إلى 10 أعوام	10 إلى 20	أكثر من 20
6	هل أنت	مالك	مستأجر	تشارك العائلة الممتدة في نفس		
7	إذا كنت مالكا هل تتوقع التوسع في البناء؟	نعم	لا	ربما	لا رأي	

Design Charrettes

Processes

The image displays a site plan map on the left and a grid of nine photographs on the right. The map shows a residential layout with a yellow dashed boundary and various colored dots (green, orange, red) indicating specific locations. The photographs show street-level conditions:

- Top-left: A steep road with a red wall and buildings.
- Top-right: A street with trees and a building.
- Middle-left: A street with a trash cart and a dirt embankment.
- Middle-right: A street with a tree and a building.
- Bottom-left: A dirt embankment and a building.
- Bottom-middle: A red wall and a building.
- Bottom-right: A concrete staircase on a hillside.

Processes

The image is a composite of several elements related to the Jofeh Neighborhood Development Project:

- Site Plan:** A topographic map of a neighborhood with a central area highlighted in green and yellow, indicating a specific development zone. A red truck is shown on a street within this zone.
- Legend:** A vertical legend on the left side of the site plan, featuring colored squares (green, yellow, blue, red) corresponding to different land use or infrastructure categories.
- Architectural Renderings:** Three 3D perspective drawings showing a modern, single-story building with a peach-colored facade and a flat roof. The renderings show the building from different angles, including a street view with a red truck and a view of the entrance with people walking.
- Photographs:** Several photographs showing existing urban infrastructure and street scenes. These include a paved street with a white truck, a trash can next to a stone wall, and a set of stone steps leading up a hillside.

Processes

CSBE

Jofeh Neighborhood Development Project

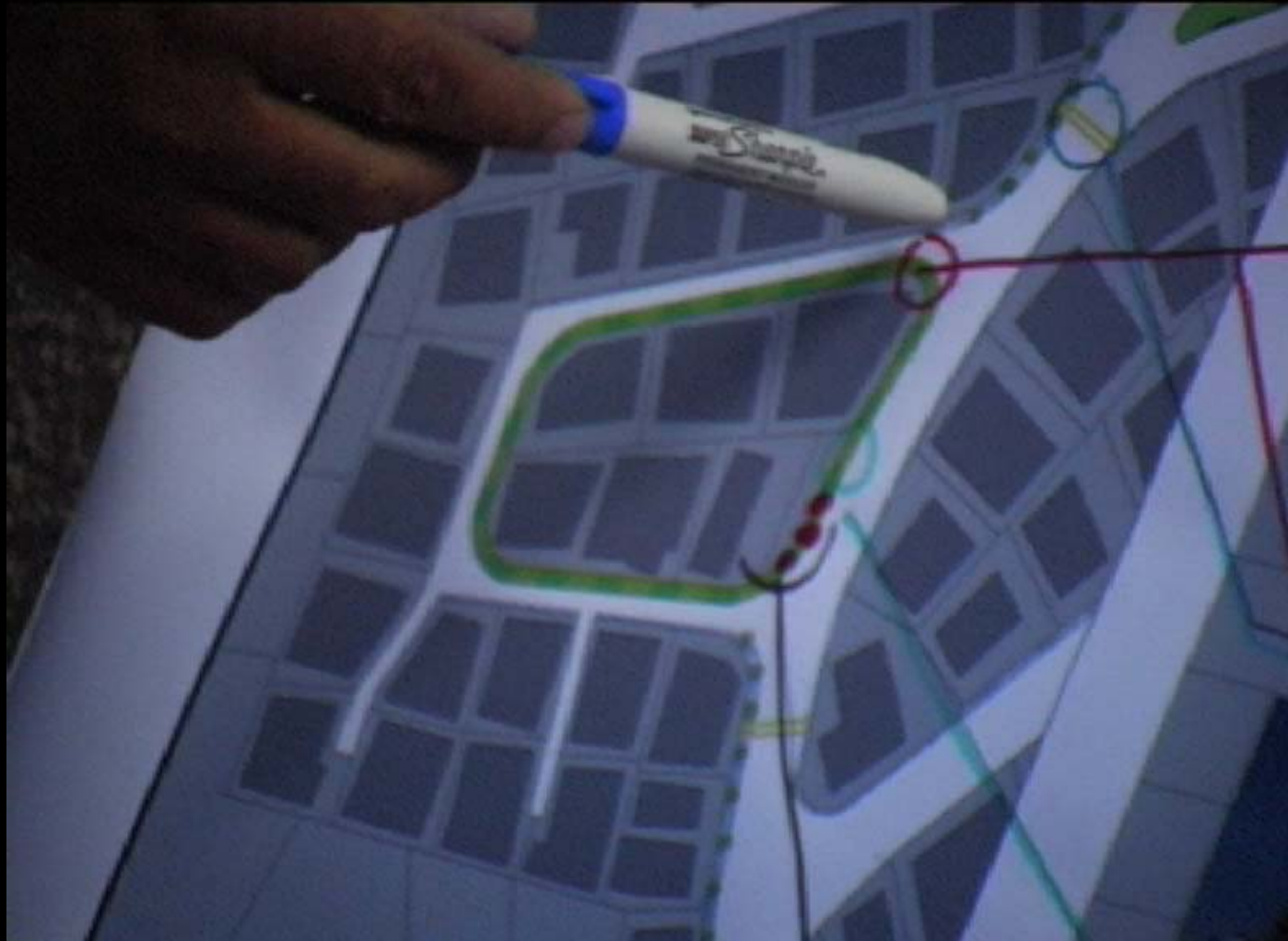

Processes

CSBE

Jofeh Neighborhood Development Project

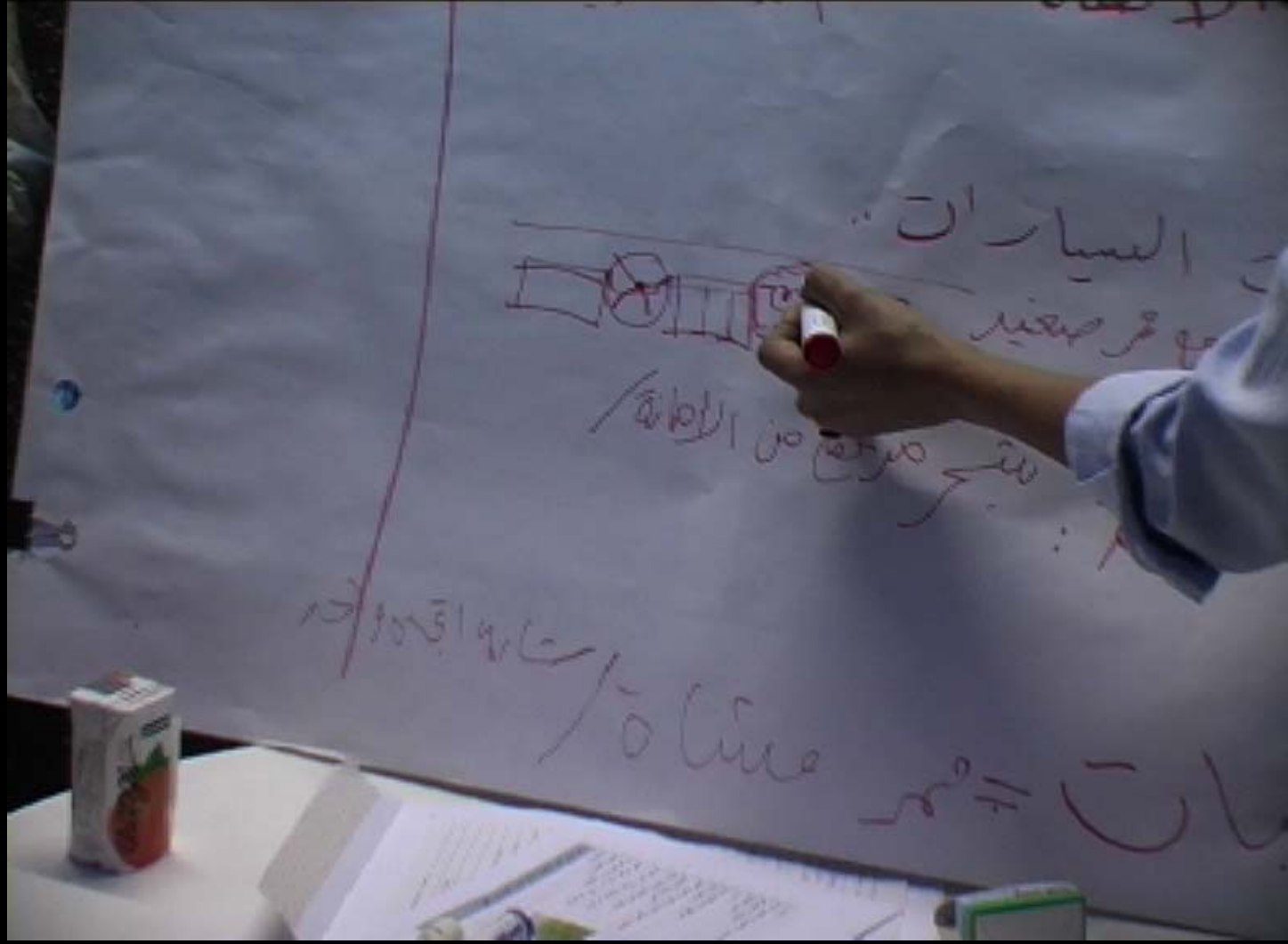

Processes

CSBE

Jofeh Neighborhood Development Project



Processes

CSBE

Jofeh Neighborhood Development Project



Processes

CSBE

Jofeh Neighborhood Development Project



Processes

CSBE

Jofeh Neighborhood Development Project



Processes

CSBE

Jofeh Neighborhood Development Project



Processes

CSBE

Jofeh Neighborhood Development Project



Processes

CSBE

Jofeh Neighborhood Development Project



Processes

CSBE

Jofeh Neighborhood Development Project



Next Steps

CSBE

Jofeh Neighborhood Development Project

- Movie production
- Final charrette
- Set of recommendations
- Website documentation
- Diwan session
- Public talk

Thank you

